

This drawing is provisional and subject to our reconfirmation and/or revision without notice.

DH1~DH2=25816 (±20)  
Stroke for PB must be minimum 600±200 μm

Coordinates

記号	X	Y	R
GM	0	0	—
DH1	3000	13000	—
DH2	2100	-12800	—
a1	3441	14908	430
a2	1865	15186	430
a3	-15151	2129	430
a4	-15291	535	430
a5	10434	-11190	430
a6	9208	-12219	430

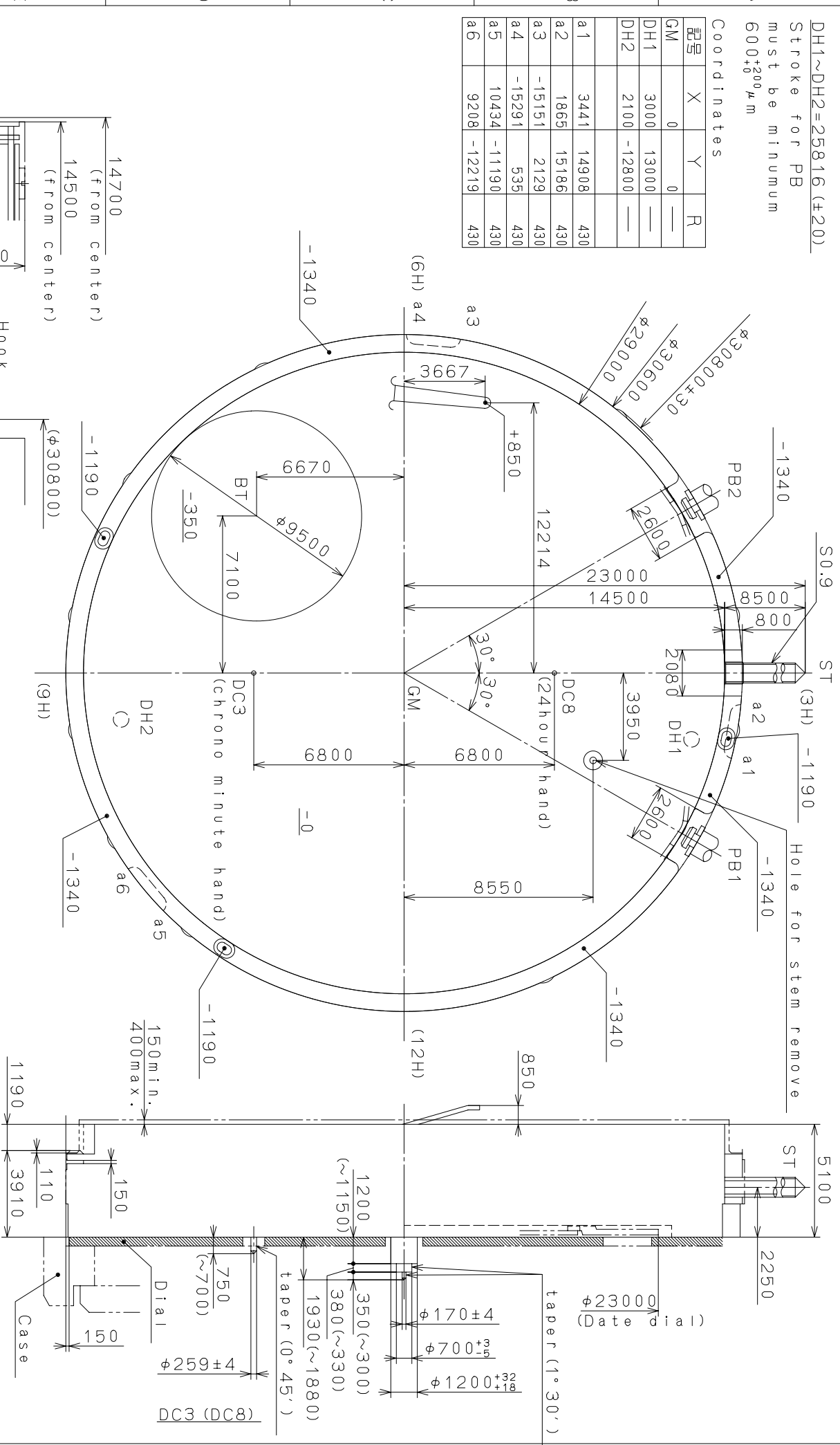

Section PB1,2

Section a1~a6

Material	Alterations	Mark Date	Description	Appr.	Checked	M. Fukuda	Name:	Frame for Case
Heat Treatment								Drawing No.: OS21C000
Hardness								
Plating								
General Tolerances	Quantity	Unit	1/1000 mm	Cal. NO.:	OS21			
	Scale	6/1		Parts No.:				
	Date							
	Drawn							
	Approved							

**MIYOTA**

CITIZEN WATCH CO., LTD. TOKYO, JAPAN

2005/10/12 (12:57:10)

This drawing is provisional and subject to our reconfirmation and/or revision without notice.

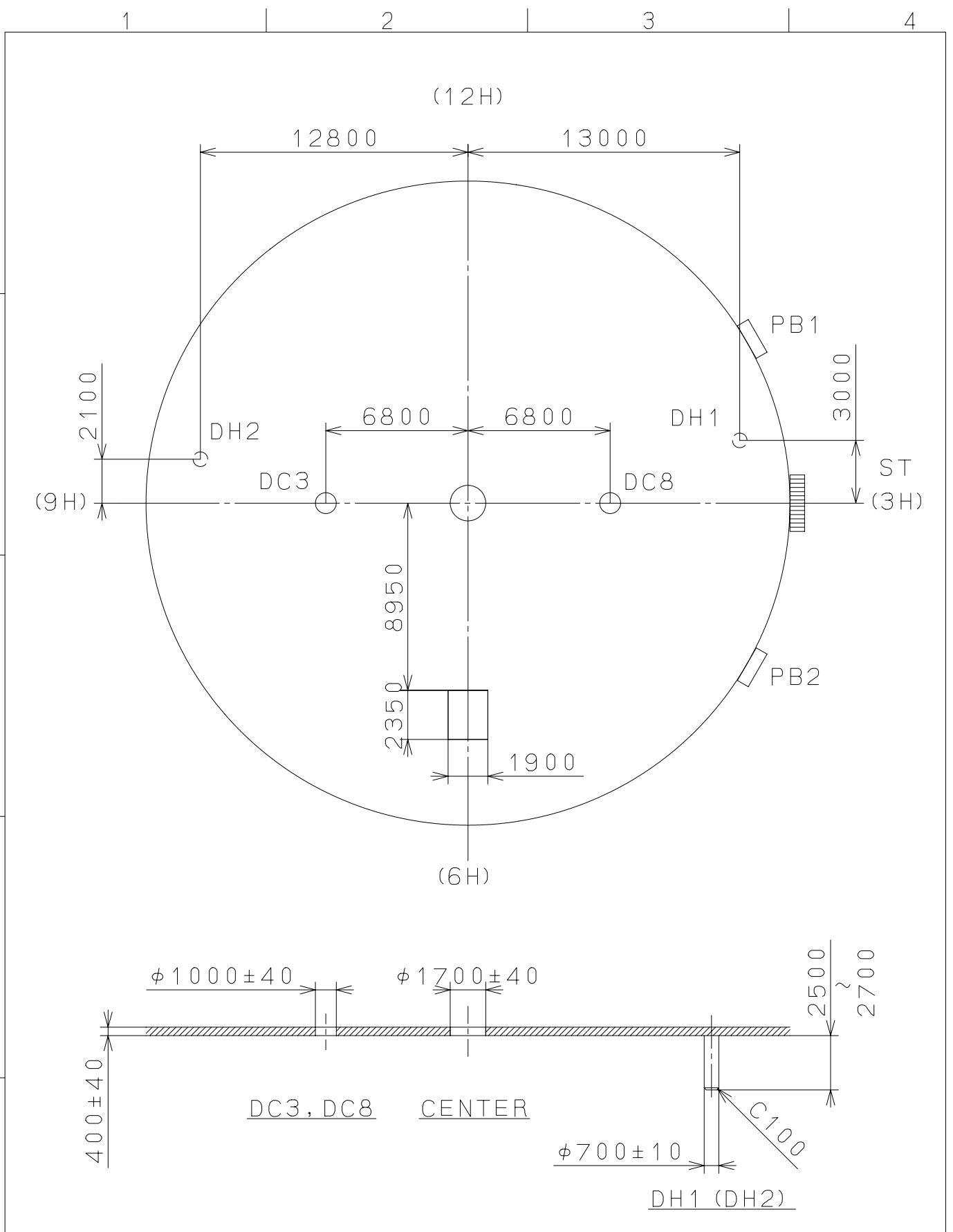

△5			Quantity		Cal. NO.:
△4			Unit	1 / 1000 mm	OS21-00Z
△3			Scale	4 / 1	Parts No.:
△2			Date		
△1			Drawn		
Mark	Date	Description	Appr.	Checked	Name:
		Alterations	Approved	M. Fukuda	Indications for Dial
Material					Drawing No.: OS21D010
Heat Treatment			General Tolerances	<b>MIYOTA</b>	
Hardness			Dimensions		
Plating			Angles		
				CITIZEN WATCH CO., LTD. TOKYO, JAPAN	

This drawing is provisional and subject to our reconfirmation and/or revision without notice.

065-453 (01) \*\*\* (2100 1121) 00-07-06

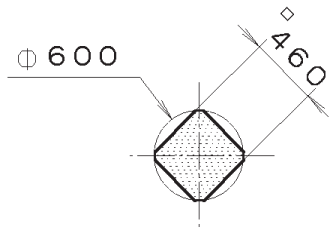

Section A-A

S.O. 9, P=0. 225mm

Φ 1000

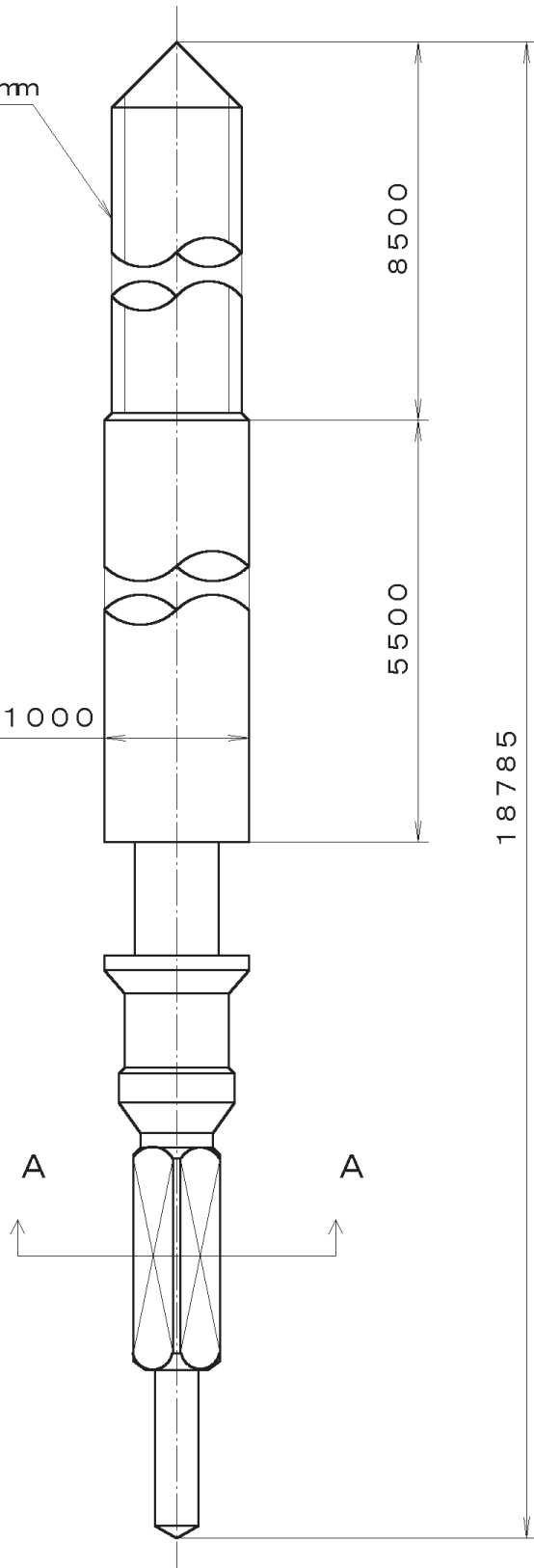

18785

7			Quantity		Cal. No. :
6			Unit	1/1000 mm	
5			Scale	20:1	Parts:
4			Date		065-453
3			Drawn		
2			Checked	T. Hiruta	Name:
1			Approved		SETTING STEM
Material					Drawing No. : 4530S000
Heat Treatment			General Tolerances		
Hardness			Dimensions		
Plating			Angles		