

This drawing is provisional and subject to our reconfirmation and/or revision without notice.

xxx T1PW 6P29 (01) xxx (2100 1121) 00-07-19

DH5~DH6=22287 (±20)

Coordinates			
Mark	X	Y	R
GM	0	0	—
DH5	-6759	6900	—
DH6	8251	-7500	—
a1	2351	11100	200
a2	7235	9131	200
a3	10800	3490	500
a4	10800	-3490	500
a5	3490	-10800	500
a6	-2700	-11100	200
a7	-5389	-10216	300
a8	-10800	-3490	500
a9	-10800	3490	500
a10	-8490	10800	500
b1	9581	6360	150
b2	7928	8931	150
b3	-5773	9946	150
b4	-7839	8415	150
b5	-8572	-6374	150
b6	-7916	-8342	150
b7	9196	-6906	150
b8	10501	-4630	150

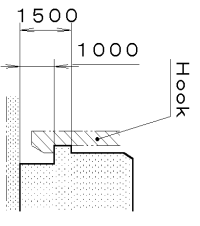
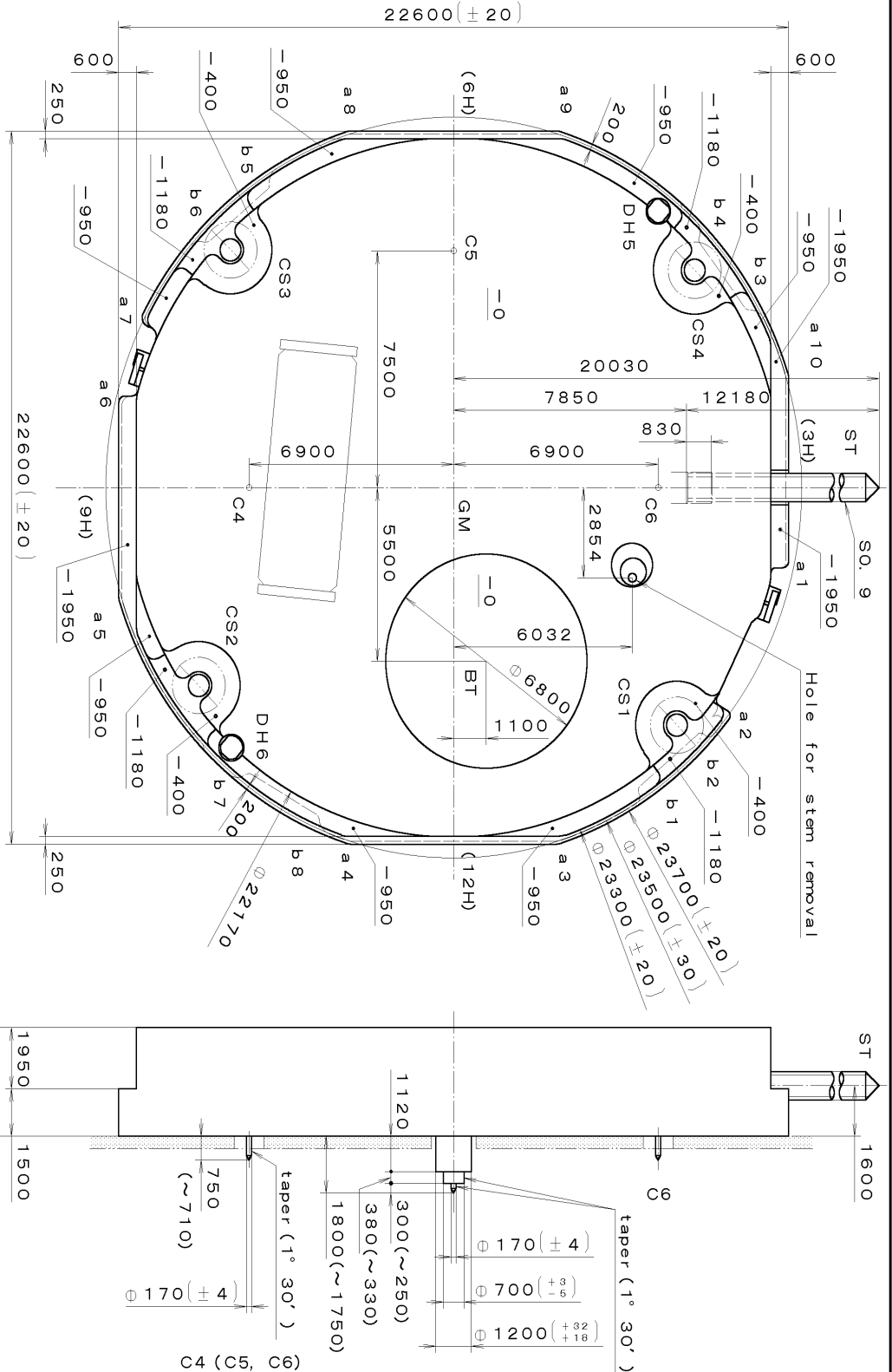

Section b1~b8

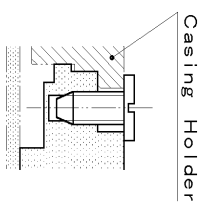

Section CS1~4

	H
With Battery strap	3600
Without Battery strap	3450

Quantity	Unit	Scale	Cal. No. :
1	1/1000 mm	7:1	6P29
Parts:			
Material			
Heat Treatment			
Hardness			
Plating			
General Tolerances			
Dimensions			
Angles			
Name: T. Hiruta			
Drawing No. : 6P29C0000			

This drawing is provisional and subject to our reconfirmation and/or revision without notice.

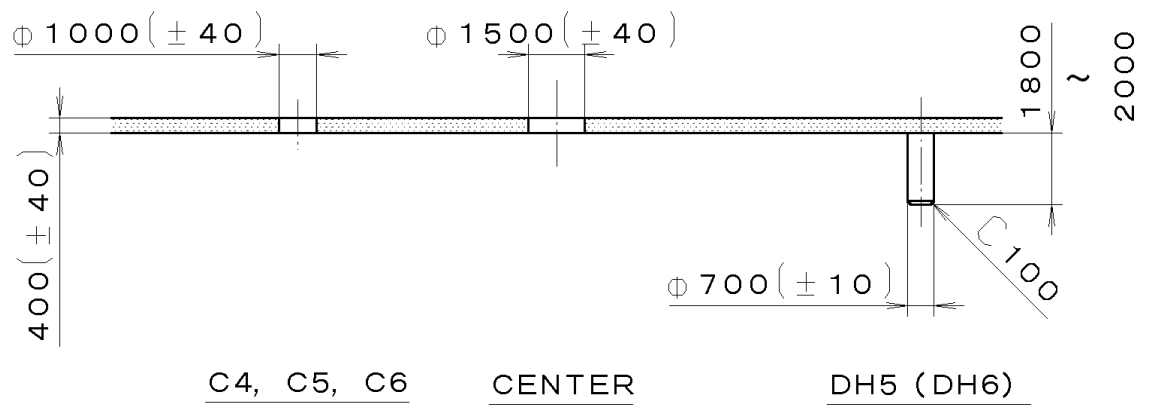
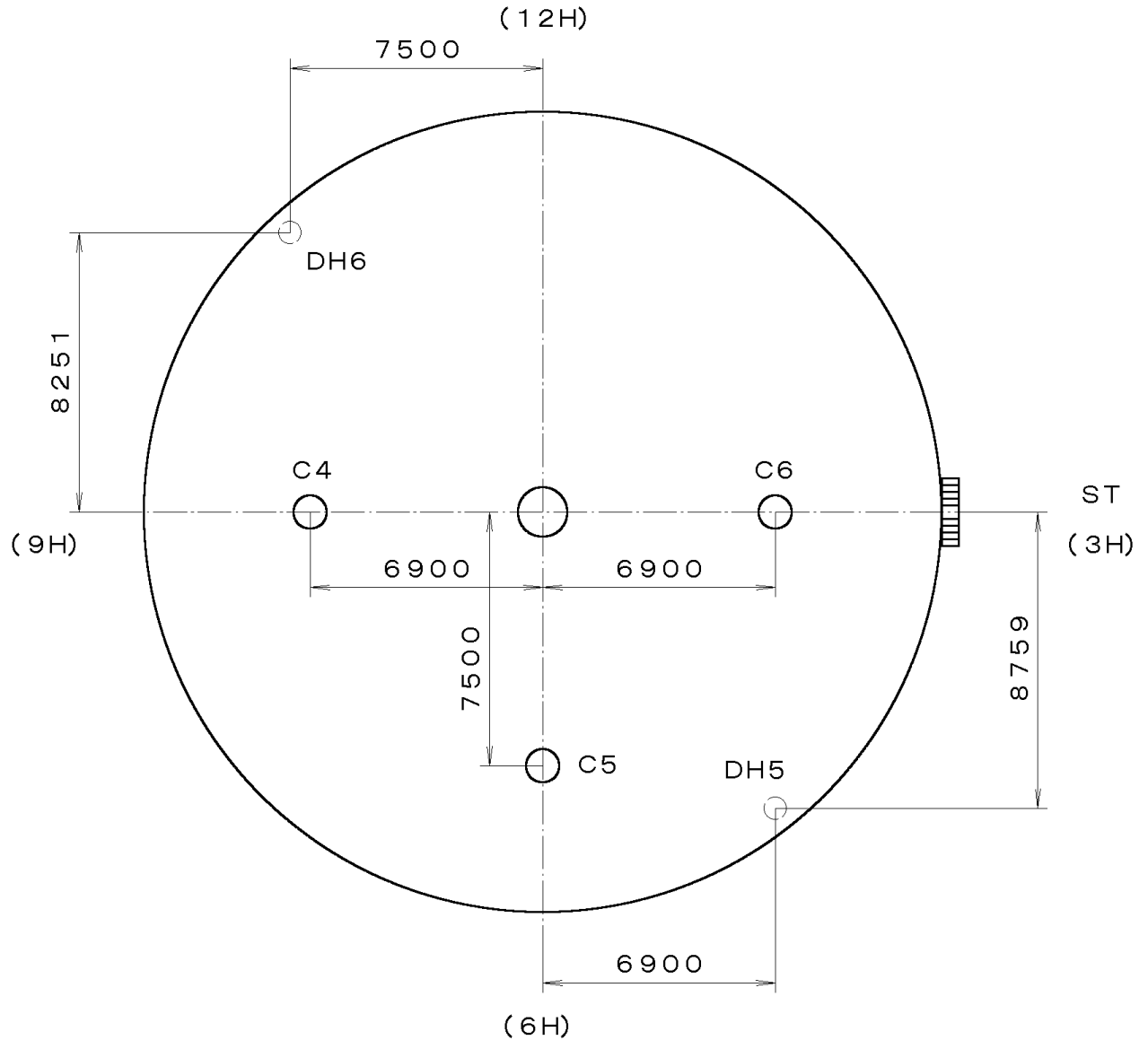

C4, C5, C6 CENTER DH5 (DH6)

*** T I P W 6P29-00A (01) *** (2100 1121)	7	Quantity	Cal. No. : 6P29-00A	
	6	Unit	1/1000 mm	
	5	Scale	5:1	
	4	Date	Parts:	
	3	Drawn		
	2	Checked		
	1	Approved	Indications for Dial	
Material	Drawing No. : 6P29D000			
Heat Treatment	General Tolerances			
Hardness	Dimensions			
Plating	Angles			

00-07-25

This drawing is provisional and subject to our reconfirmation and/or revision without notice.

065-379 (01) *** (2100 1121) 00-06-23

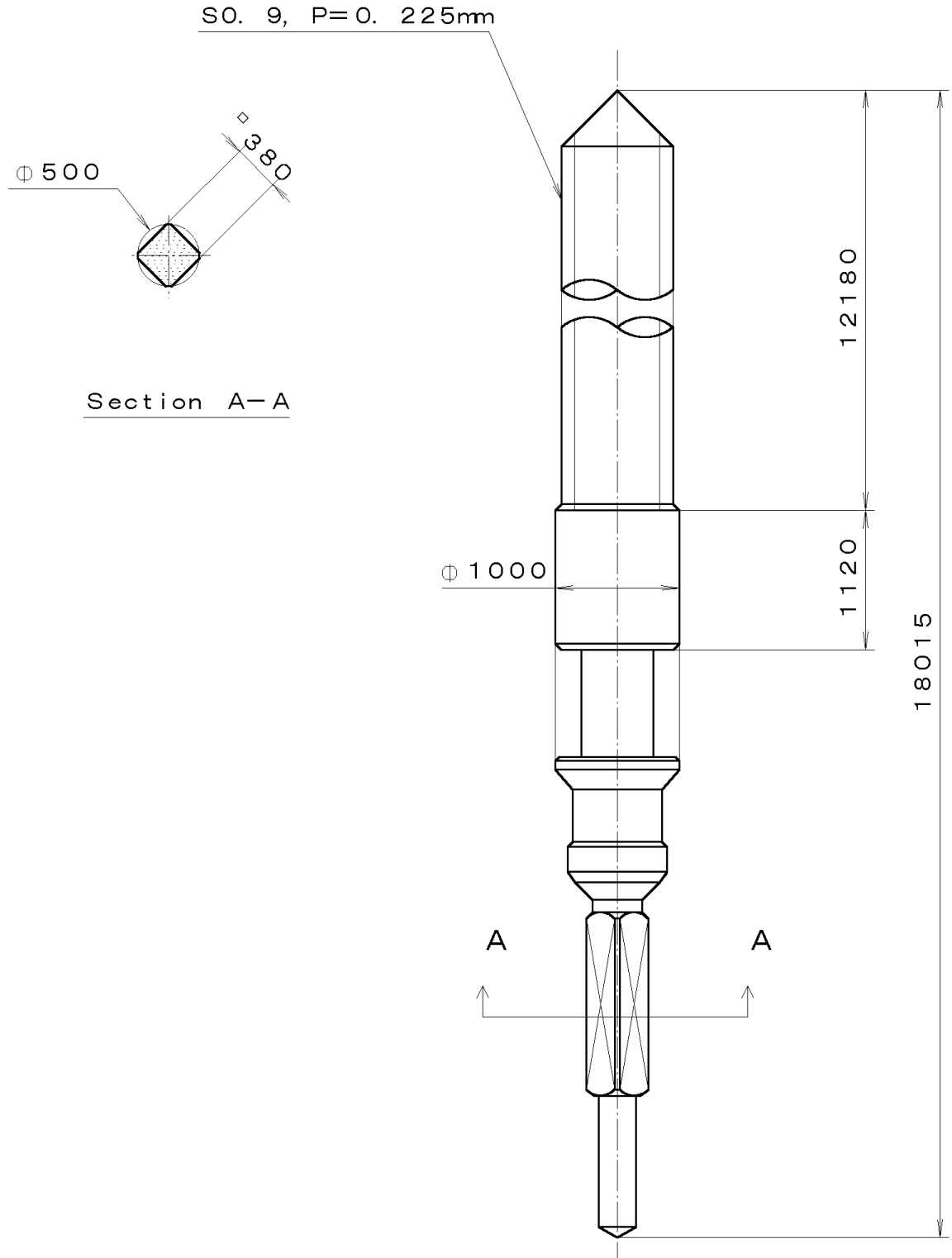

7		Quantity		Cal. No. :
6		Unit	1/1000 mm	Parts:
5		Scale	20:1	
4		Date		
3		Drawn		Name:
2		Checked	T. Hiruta	
1		Approved		SETTING STEM
Material				Drawing No. : 3790S000
Heat Treatment		General Tolerances		
Hardness		Dimensions		
Plating		Angles		