

DH1~DH2=16171 (±20)

Coordinates

Mark	X	Y
GM	0	0
DH1	-7900	-3000
DH2	8234	-1900

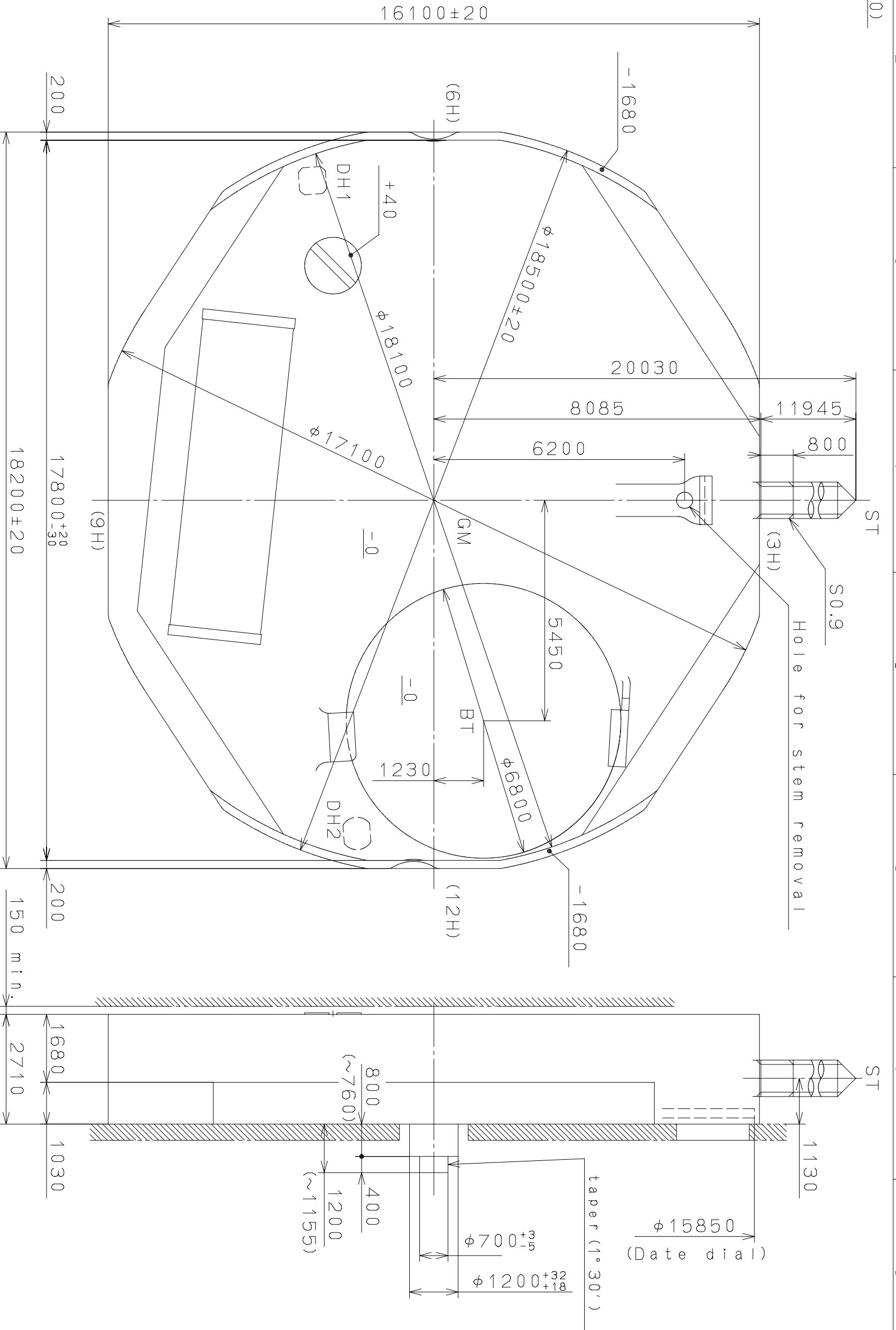

△	Quantity	1/1000 mm	Cal. NO.: GL17
△	Unit	10:1	Parts No.:
△	Scale		
△	Date		
△	Drawn		
△	Checked	M. Fukuda	Name:
△	Approved		Frame for Case
Material	Alterations		Drawing No.: GL15C0AS
Heat Treatment			
Hardness	General Tolerances		MIYOTA
Plating	Dimensions		CITIZEN WATCH CO., LTD. TOKYO, JAPAN
	Angles		

This drawing is provisional and subject to our reconfirmation and/or revision without notice.

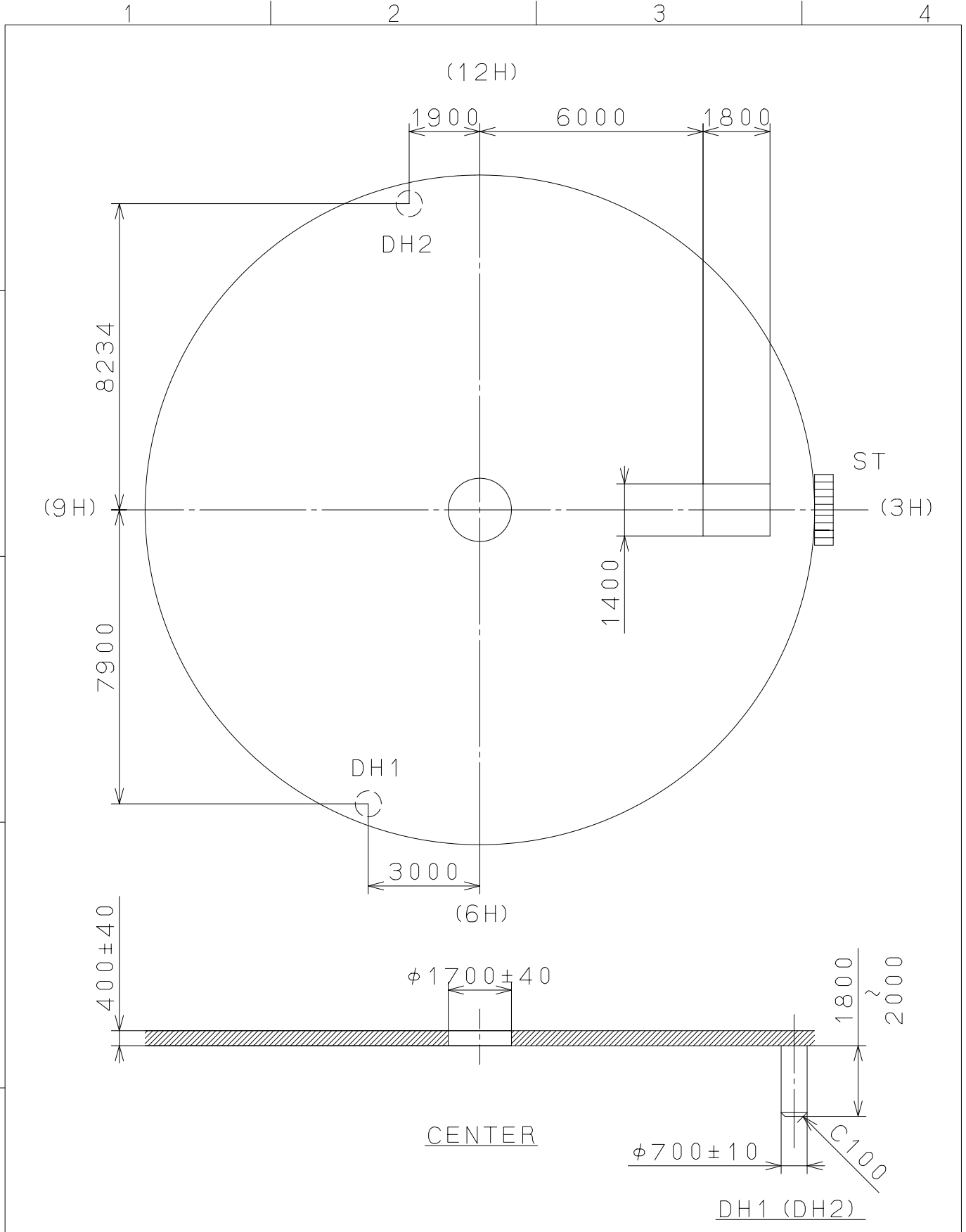

⑤			Quantity			Cal. NO.: GL17-10A
④			Unit	1 / 1000 mm		
③			Scale	7 / 1		Parts No.:
②				Date	Name	
①			Drawn			
Mark	Date	Description	Appr.	Checked	M. fukuda	Name:
Alterations			Approved			Indications for Dial
Material					Drawing No.: GL15D000	
Heat Treatment					General Tolerances	
Hardness					Dimensions	
Plating					Angles	

This drawing is provisional and subject to our reconfirmation and/or revision without notice.

*** T I P W 065-547 (01) *** (2100 1121) 02-07-12

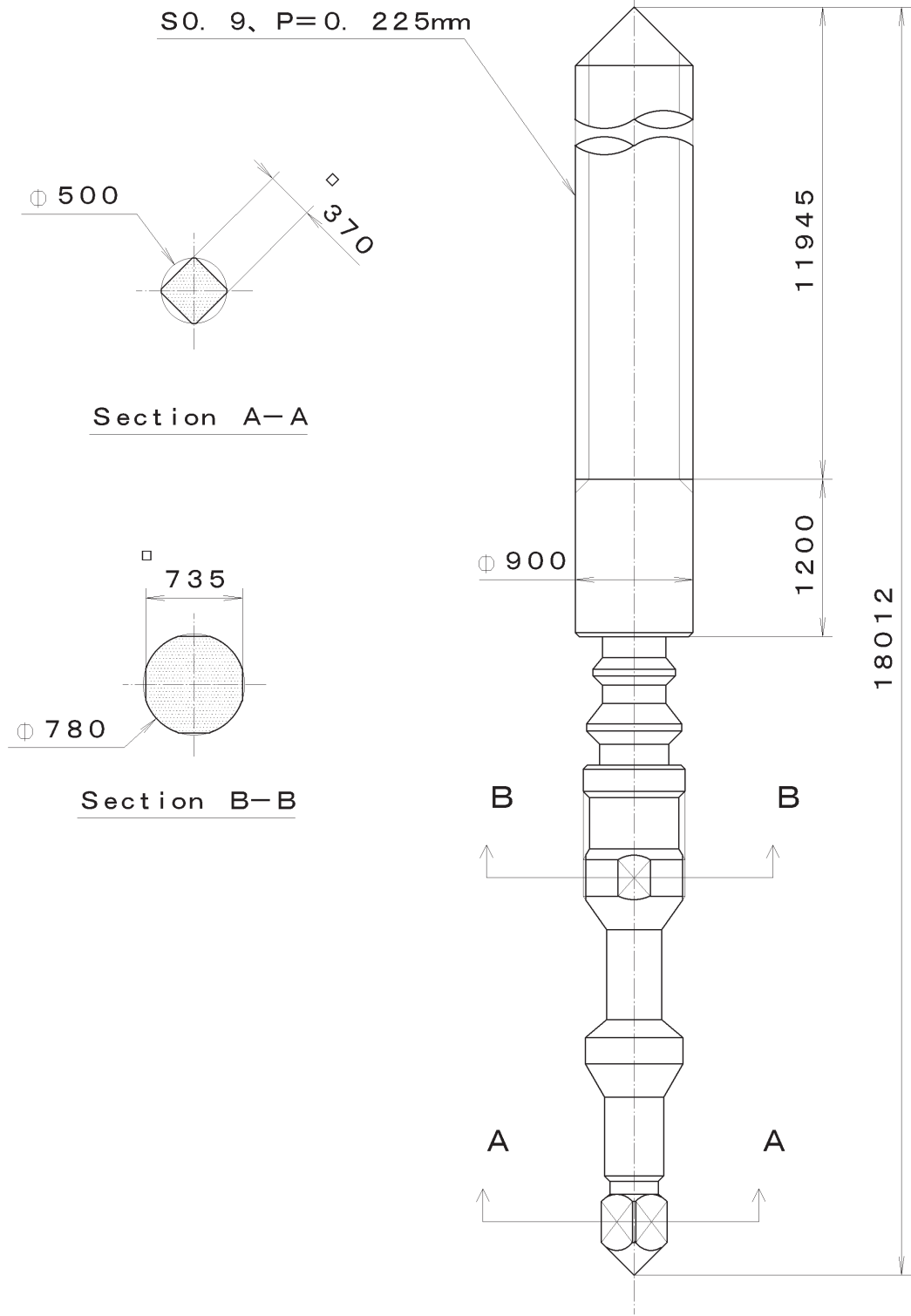

7			Quantity		Ca l. No. :
6			Unit	1/1000 mm	
5			Scale	20:1	Parts:
4			Date		065-547
3			Drawn		Name:
2			Checked	T. Hiruta	SETTING STEM
1			Approved		Drawing No. : 5470S000
Material					MIYOTA
Heat Treatment			General Tolerances		
Hardness			Dimensions		
Plating			Angles		